

ATTACHMENT "AA"

IES RISK RATINGS

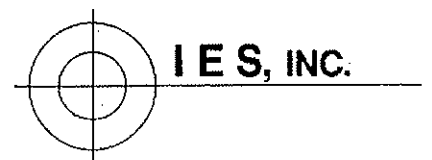

ATTACHMENT "AA"
IES CLEANUP RISK RATINGS

- **High Cleanup Risk:** Documented environmental "problems" at the site, which are considered likely to require remedial activities at the subject site. Environmental "problems" include documented spills or releases at the site or visual evidence of a release (staining, stressed vegetation, etc.) at the site. Also, significant potential on-site sources of contamination, including past or existing underground storage tanks at the site which have exceeded their expected lifespan; or historical usage of the site likely to lead to contamination (industrial, automotive repair, dry cleaner, etc.), particularly if a dry well or on-site septic system is, or has been, utilized. Due to the availability of a "Downgradient Property Status" (DPS) submittal, off-site threats of contamination resulting in a "High Risk" are limited to those significant enough to potentially require the site owner to perform actions necessary to "prevent, eliminate, or minimize danger to health, safety, public welfare and/or the environment".
- **Moderate Cleanup Risk:** Documented/observed environmental releases or threats of release at the subject site that may pose an environmental threat to the site, but where the actual threat could not be conclusively determined. High Risk Businesses may be considered "Moderate Risk" if there is no record of underground storage tanks, no dry wells, and disposal is and has been via the municipal sewer system, rather than an on-site septic system. Also, on-site sources of contamination or releases which have been addressed. For example, an RAO, NFA or comparable status for an on-site release; a satisfactory UST removal report; or relatively new underground tanks, with proper monitoring devices.
- **Low Cleanup Risk:** No apparent visual or historical evidence to indicate that a release or threat of release would impact the site from an on-site source. Nearby DEP/EPA listed properties are either at a sufficient distance, down gradient location, or minor in nature so as not to pose a significant environmental threat; and there is no evidence that any off-site threats of contamination would require any site activities beyond the completion of a DPS submittal. Minor pavement staining and the presence of cleaning products or above ground tanks in good condition is not necessarily evidence of a release or threat of release.

Please note that the presence or absence of release can not be conclusively determined without the benefit of a subsurface investigation, and therefore, "Low Cleanup Risk" should not be construed as a conclusive determination of a site, which does not exhibit a release.

The above refers to environmental risks only, and does not address asbestos, lead paint or radon. Financial or liability risks may be dependent on the applicability of a Downgradient Property Status (DPS) submittal.

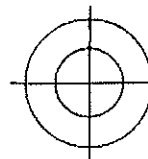

IES, INC.

ATTACHMENT "AAA"

IES Environmental Risk Rating

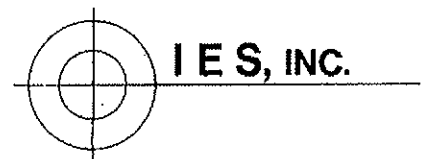

ATTACHMENT "AAA"
IES ENVIRONMENTAL RISK RATINGS

- **High Environmental Risk:** Documented environmental "problems" at the site, at abutting properties, or at nearby up gradient properties, which are considered likely to affect the subject site. Environmental "problems" include documented spills or releases at the site or nearby properties, or visual evidence of a release (staining, stressed vegetation, etc.) at the site. Also, significant potential sources of contamination, including past or existing underground storage tanks at or in the immediate vicinity of the site which have exceeded their expected lifespan; or historical usage of the site or nearby properties likely to lead to contamination (industrial, automotive repair, dry cleaner, etc.), particularly if a dry well or on-site septic system is, or has been, utilized.
- **Moderate Environmental Risk:** Documented/observed environmental releases or threats of release at nearby properties that may pose an environmental threat to the site, but where the actual threat could not be conclusively determined. High Risk Businesses may be considered "Moderate Risk" if there is no record of underground storage tanks, no dry wells, and disposal is and has been via the municipal sewer system, rather than an on-site septic system. Also, on-site sources of contamination or releases which have been addressed. For example, an RAO, NFA or comparable status for an on-site release; a satisfactory UST removal report; or relatively new underground tanks, with proper monitoring devices.
- **Low Environmental Risk:** No apparent visual or historical evidence to indicate that a release or threat of release would impact the site, either from on-site or off-site sources. Nearby DEP/EPA listed properties are either at a sufficient distance, down gradient location, or minor in nature so as not to pose a significant environmental threat. Minor pavement staining and the presence of cleaning products or above ground tanks in good condition is not necessarily evidence of a release or threat of release.

Please note that the presence or absence of release can not be conclusively determined without the benefit of a subsurface investigation, and therefore, "Low Environmental Risk" should not be construed as a conclusive determination of a site, which does not exhibit a release.

The above refers to environmental risks only, and does not address asbestos, lead paint or radon. Financial or liability risks may be dependent on the applicability of a Downgradient Property Status (DPS) submittal.

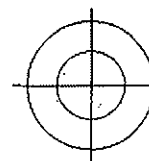

IES, INC.

ATTACHMENT "A"

FIGURES & PHOTOGRAPHS

**USGS Quadrangle Map
Somerville Assessor's Map
Photographs**

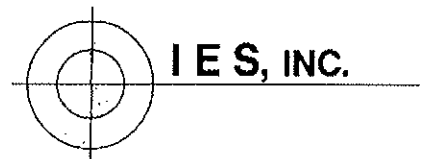

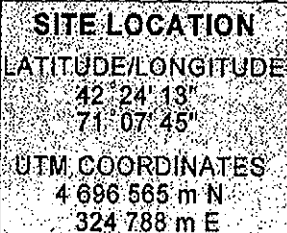

CONTOUR INTERVAL 3 METERS
DATUM MEAN SEA LEVEL

IES, INC.
ENVIRONMENTAL CONSULTANTS

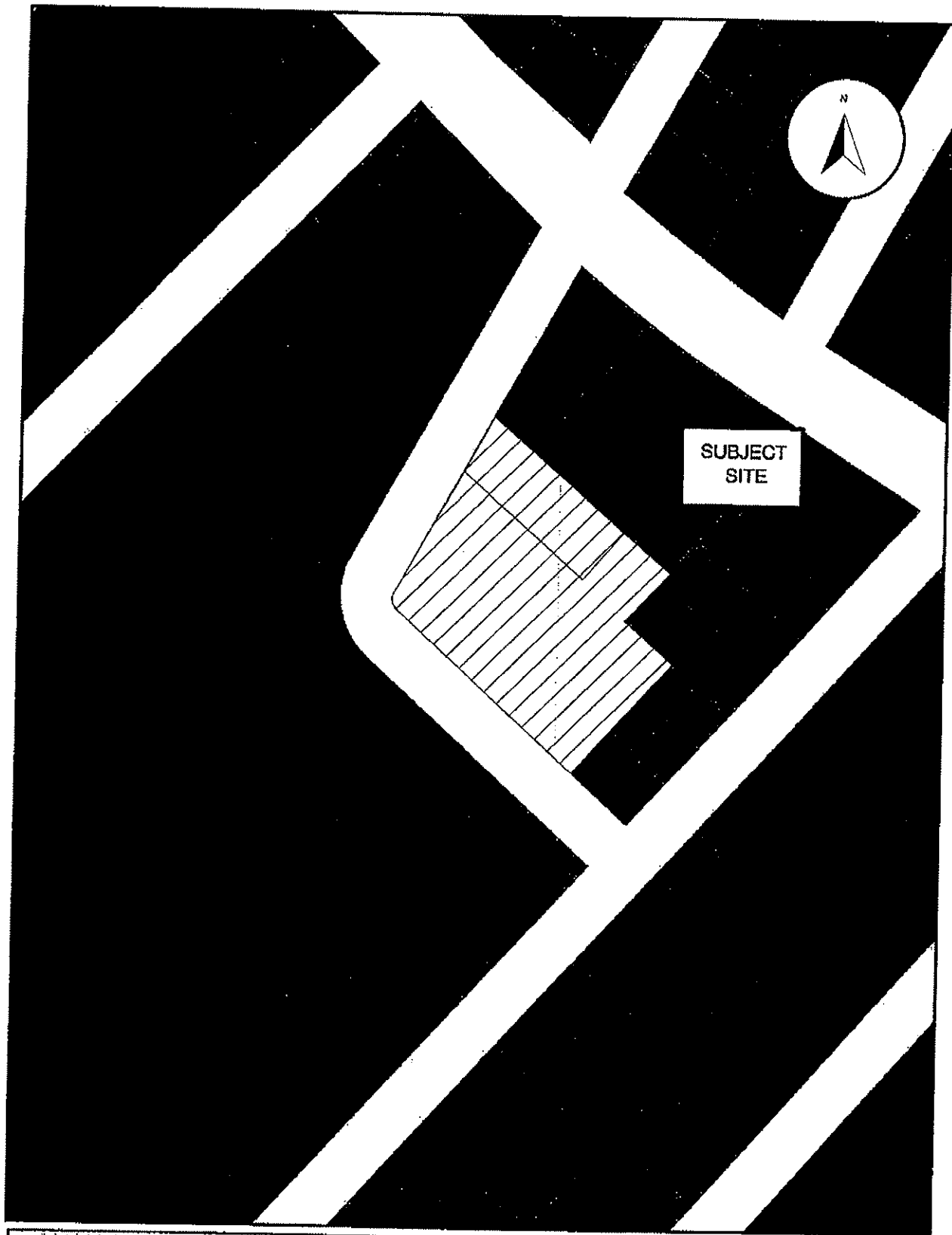

CITY OF SOMERVILLE
ASSESSOR'S MAP #9

26 WESTON AVENUE,
SOMERVILLE, MA

APPROXIMATE SCALE



FIGURE 2

IES, INC.
ENVIRONMENTAL CONSULTANTS