

PARKING COUNT:

EXISTING (REAR OF BUILDING): 158 (16 converted to compact spaces)

EXISTING (FRONT OF BUILDING): 25

PROPOSED (REAR OF BUILDING): 2

PROPOSED (TOP SIDE OF BUILDING): 17

PROPOSED (FRONT SIDE OF BUILDING): 7

TOTAL: 209

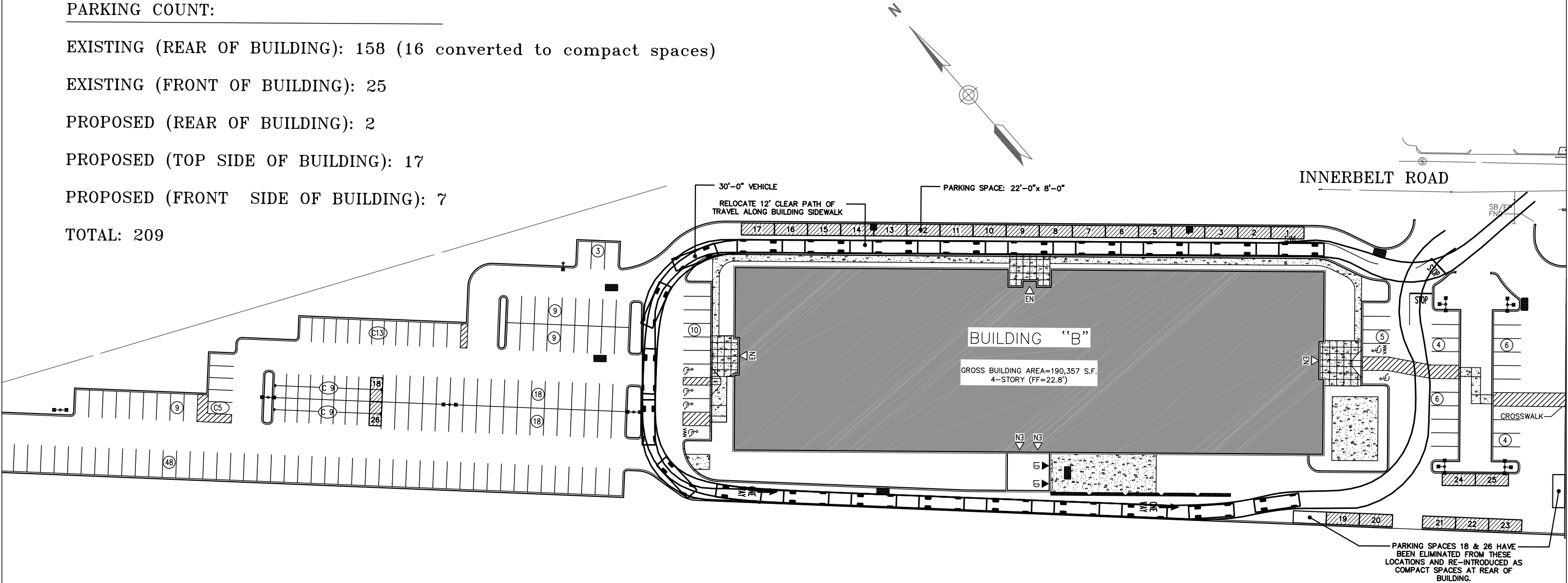

Foulger-Pratt Development, Inc.
9600 Blackwell Road, Suite 200
Rockville, MD 20850

200 INNER BELT ROAD
SOMERVILLE, MA

PARKING PLAN - OPTION 3

Conner Design
architecture interiors visualization

50 Terminal Street,
Bldg #2, 6th Floor
Charlestown, MA 02129
617.241.8300
617.241.8303 fax

Project No: 1107

Issue Date: 02 MAY, 2011

SCALE: 1/64"=1'-0"

A100-03R4

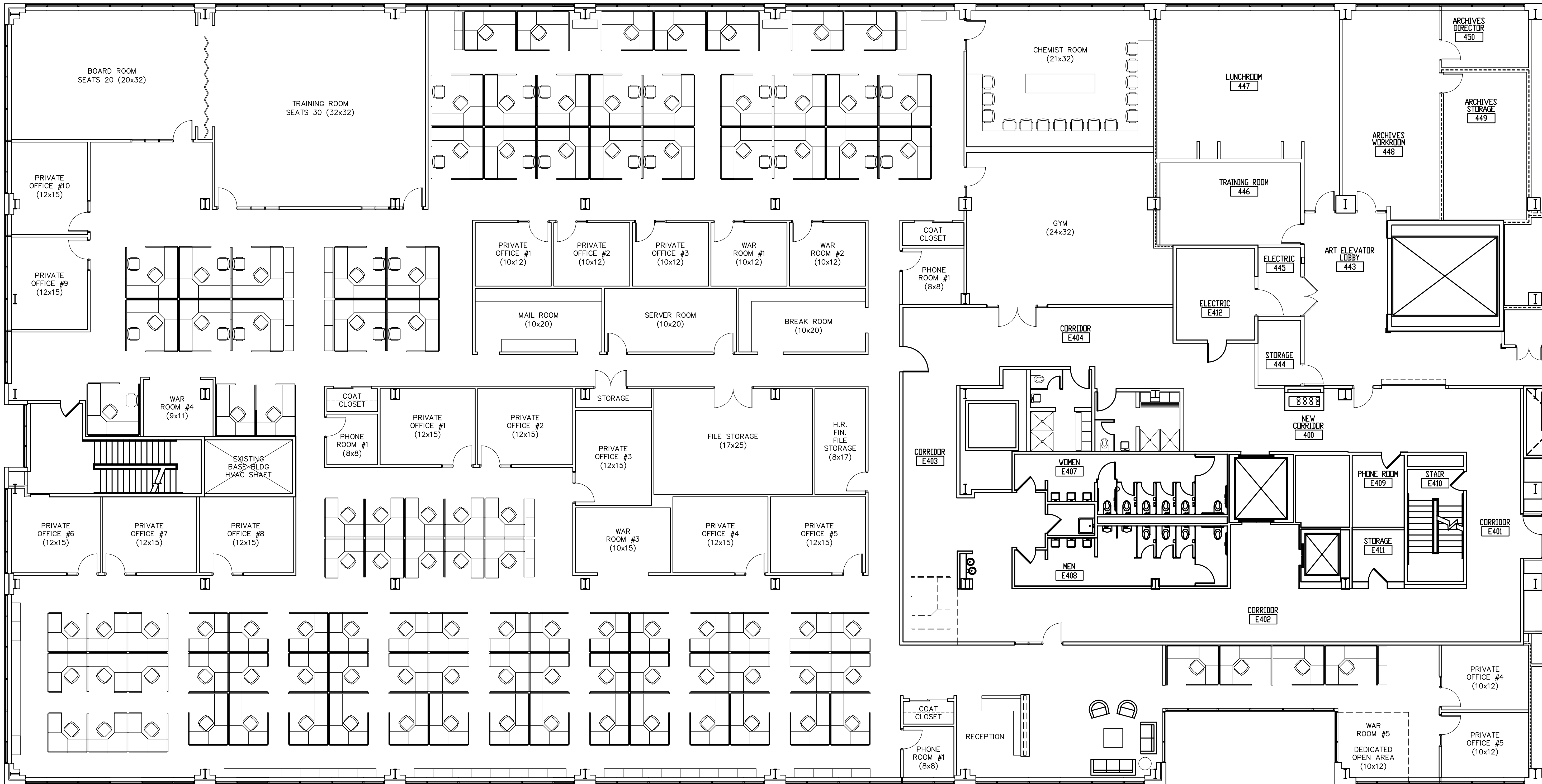

TRIUMVIRATE

200 INNER BELT ROAD
SOMERVILLE, MA

SPACE PLANNING
REVIEW SET

Conner Design
architecture interiors visualization

50 Terminal Street,
Bldg #2, 6th Floor
Charlestown, MA 02129
617.241.8300
617.241.8303 fax

Project No: 1021

Issue Date: 11-03-2010

BULL-NO

Revisions:		
No	Date	Description
1	10-12-2010	Schematic 1
2	10-14-2010	Schematic 2
3	10-15-2010	Schematic 3

4TH FLOOR PLAN

TEST FIT PLAN

1/8"=1'-0"

A101