

EXISTING

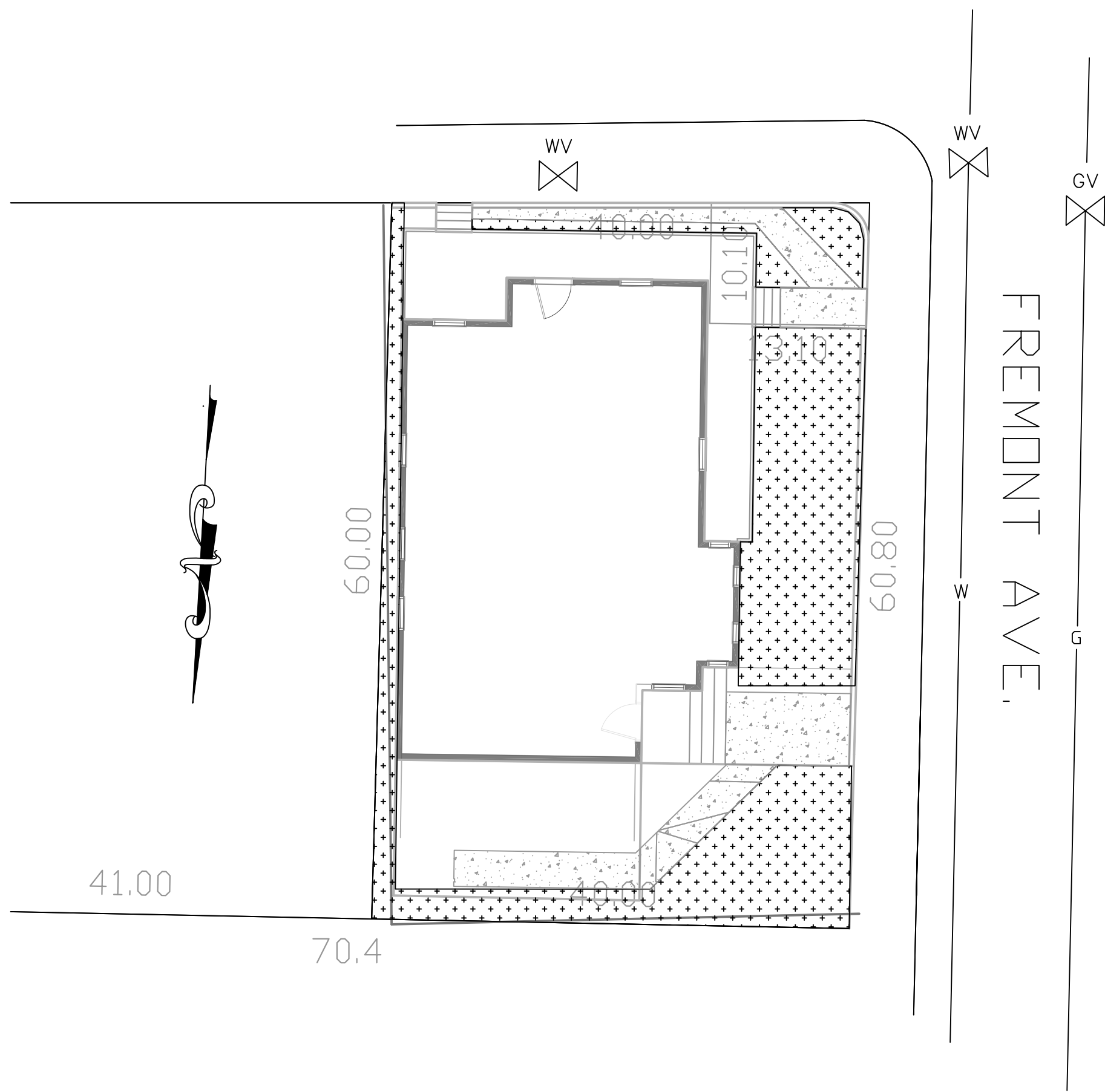

PROPOSED

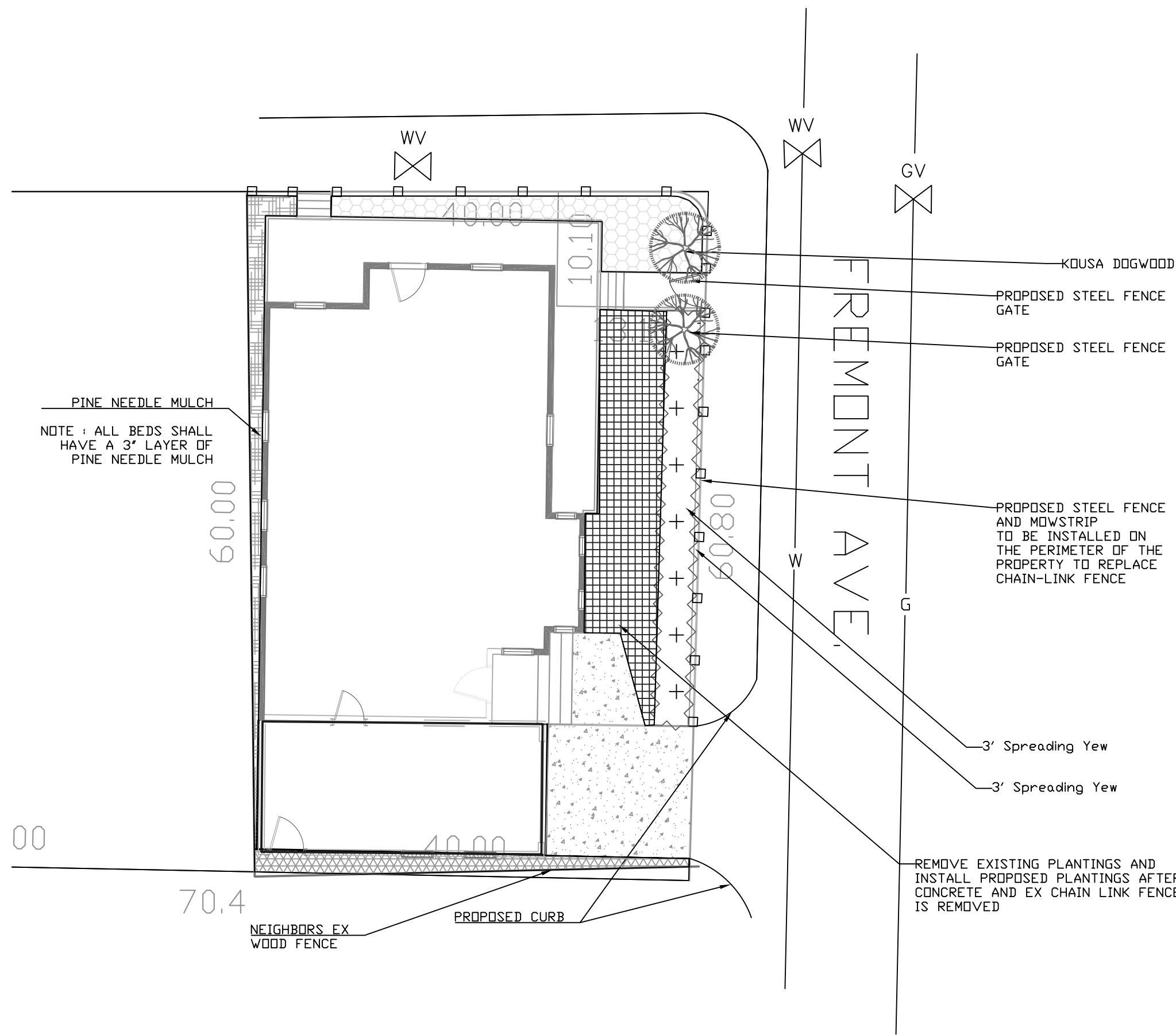

*NOTE: ALL AREAS SHOWN ARE APPROXIMATE
AND ARE IN FEET AND ARE ROUNDED TO TENTHS

REFERENCES
DEED BK. 65509 PG. 291
ASSESSORS MAP 75 BLOCK C #2
ZONING DISTRICT RB (RESIDENCE B) FROM ASSESSOR'S DATABASE

I HEREBY CERTIFY THAT THE PROPERTY LINES SHOWN HEREON ARE THE LINES DIVIDING EXISTING OWNERSHIPS, AND THE LINES OF STREETS AND WAYS SHOWN ARE THOSE OF PUBLIC OR PRIVATE STREETS ALREADY ESTABLISHED, AND THAT NO NEW LINES FOR DIVISION OF EXISTING OWNERSHIP OR FOR NEW WAYS ARE SHOWN.

I HEREBY CERTIFY THIS PLAN CONFORMS TO THE RULES AND REGULATIONS OF THE REGISTRY OF DEEDS

WILLIAM R. D'ENTREMONT, PLS
REG. PROF. LAND SURVEYOR

DATE

I CERTIFY THAT THIS PLAN FULLY & ACCURATELY DEPICTS THE LAYOUT, LOCATION, UNIT NUMBERS, AREAS & DIMENSIONS OF THE UNITS AS THEY HAVE BEEN BUILT. THIS PLAN WAS PREPARED IN ACCORDANCE WITH THE RULES & REGULATIONS OF THE REGISTRY OF DEEDS.

ROBERT E. MARINI, PE
REG. PROF. ENGINEER

DATE

LEGEND & SYMBOLS

•	MONUMENTATION
IPIPE	IRON PIPE
IR	IRON ROD
CB	CATCH BASIN
HYDRANT	HYDRANT
GV	GAS VALVE
WV	WATER VALVE
GL	GAS LINE
OW	OVERHEAD WIRES
WL	WATER LINE
EG	EXISTING GRADE
CL	COLUMN LINE
BLK	BULKHEAD
PF	PROPOSED FENCE
ELS	EXISTING LANDSCAPED SPACE
C	CONCRETE

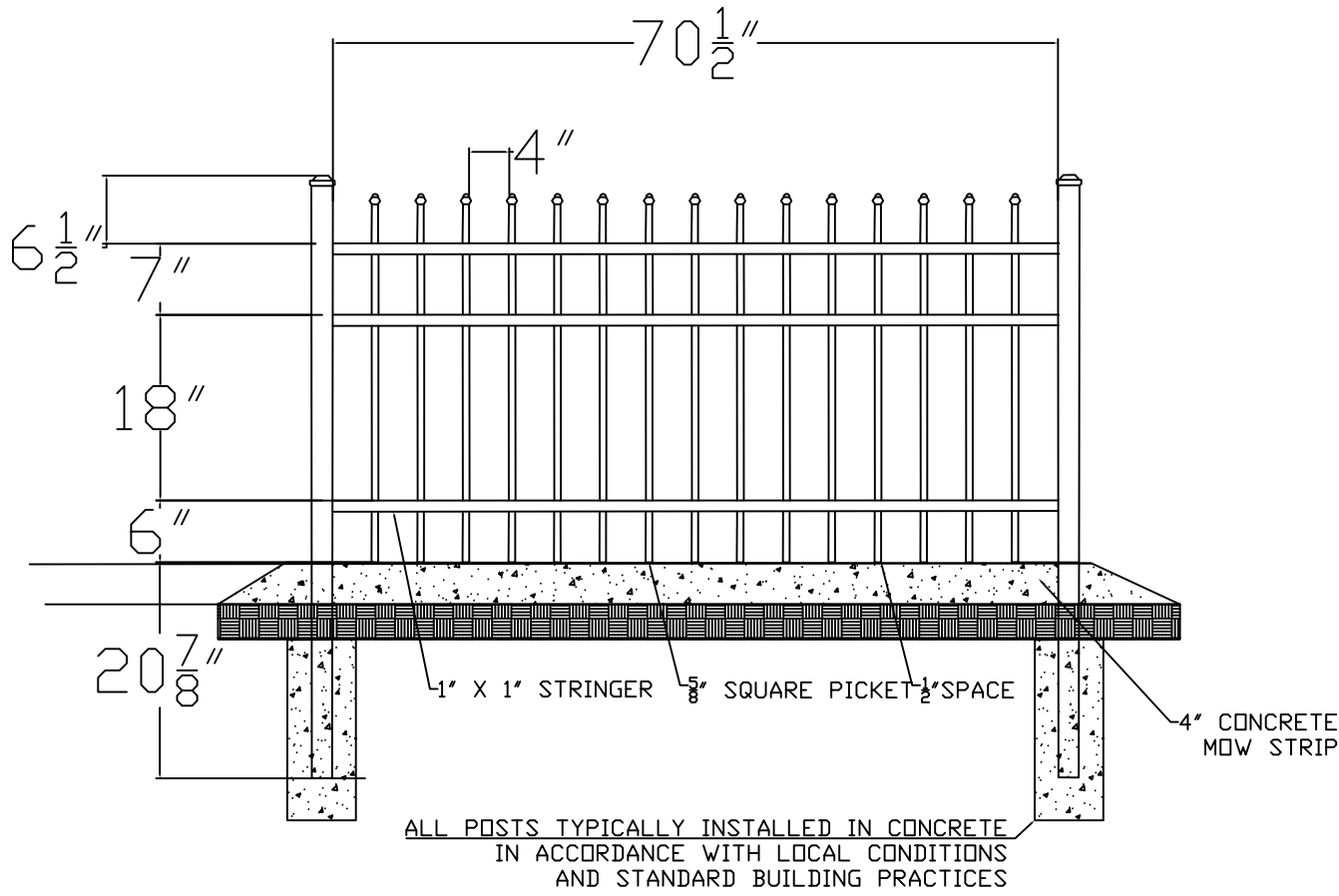

FENCE DETAIL

Condominium Site Plan & Survey
For
Deborah Lucas
at
1 Fremont Ave
Somerville, MA

PREPARED FOR:
Deborah Lucas
1 Fremont Ave
Somerville, MA

NativeTEC

ENVIRONMENTAL SCIENCE, CIVIL ENGINEERING, LANDSCAPE ARCHITECTURE & SURVEY
31 MUNROE STREET LYNN, MASSACHUSETTS 01901
TEL 617.437.6461 FAX 239.236.0444

DATE IN
3-4-2016
DRAWN BY
K.K.
CHECKED BY
R.E.M.
SCALE
1:10

LAYOUT